



On-Campus Housing for Students

Department of Residence Life

Department of Transportation

Dining Services

Department of Information Technology

Residential Housing Association

- Who are we?
 - The Governing Body for all of the Residence Halls on campus, including the White Creek
 - We represent all of the residents who live on campus with the exception of the Corps of Cadets and Garden's Apartments



What does RHA do as a whole?

- Host campus wide events for all students
- Uniting the on campus residents
- Developing leaders across campus
- Partner with elite organizations to co-program and enhance the Aggie experience
- Work as a group to solve issues that are relevant to students living on campus
- We are involved with both regional and national organizations
- Care Packages!



Attendance at Conferences

- SWACURH
 - Regional conference
 - Meeting other RHA involved schools from Arkansas, Louisiana, Oklahoma, Texas and Mexico
 - Recently hosted here at Texas A&M
- NACURH
 - National Conference includes US, Mexico and Canada



How Can You Get Involved?

- Community Councils in every hall
- Officer Positions for Community Councils include President, Executive Vice President, RHA Reps, Secretary and others
- Actively include all of the residents in your Hall
- Host your own Hall event OR partner with other surrounding Halls
- Participate in large RHA events





@tamu_rha
#tamuRHA



Texas A&M Residential
Housing Association



@tamu_rha
#tamuRHA

Thanks and Gig 'Em!





**TRANSPORTATION
SERVICES**

Permit Registration

Online Permit Registration

April 6 - July 6

log into MY ACCOUNT



Permit Registration

- **Register for your parking permit!**
- Choose student lots/garages near your hall or apartment
- Parking opposite dorm? Let us know!
- *White Creek parking is lot 122

Campus Parking

Get real-time occupancy for visitor parking areas

iPhone and Android

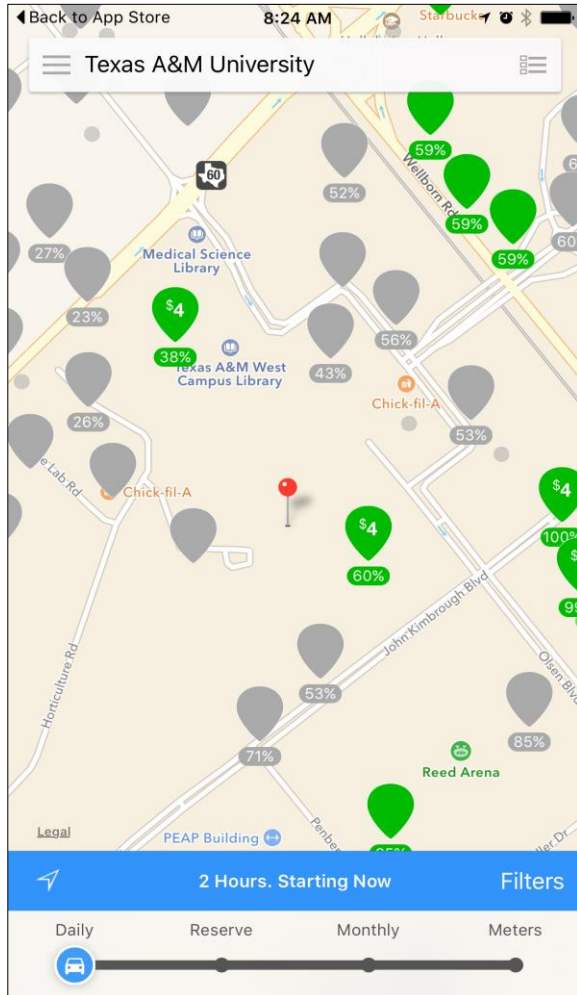

Parkme

Transit Service On Campus / Off Campus

AggieSpirit 01 04/26/2016

Show Expired Leave Times

01 Bonfire 4/26/2016

Leave				Arrive
Trigon	Asbury Water Tower	Wehner	Reed Arena	Trigon
09:22A	09:29A	09:37A	09:42A	09:47A
09:28A	09:35A	09:43A	09:48A	09:53A
09:34A	09:41A	09:49A	09:54A	09:59A
09:40A	09:47A	09:55A	10:00A	10:05A
09:46A	09:53A	10:01A	10:06A	10:11A
09:52A	09:59A	10:07A	10:12A	10:17A
09:58A	10:05A	10:13A	10:18A	10:23A
10:04A	10:11A	10:19A	10:24A	10:29A
10:10A	10:17A	10:25A	10:30A	10:35A
10:16A	10:23A	10:31A	10:36A	10:41A
10:22A	10:29A	10:37A	10:42A	10:47A
10:28A	10:35A	10:43A	10:48A	10:53A
10:34A	10:41A	10:49A	10:54A	10:59A
10:40A	10:47A	10:55A	11:00A	11:05A
10:46A	10:53A	11:01A	11:06A	11:11A
10:52A	10:59A	11:07A	11:12A	11:17A
10:58A	11:05A	11:13A	11:18A	11:23A
11:04A	11:11A	11:19A	11:24A	11:29A
11:10A	11:17A	11:25A	11:30A	11:35A
11:16A	11:23A	11:31A	11:36A	11:41A
11:22A	11:29A	11:37A	11:42A	11:47A
11:28A	11:35A	11:43A	11:48A	11:53A
11:34A	11:41A	11:49A	11:54A	11:59A
11:40A	11:47A	11:55A	12:00P	12:05P
11:46A	11:53A	12:01P	12:06P	12:11P
11:52A	11:59A	12:07P	12:12P	12:17P

Visit transport.tamu.edu/busroutes for real-time bus locations



Real Time Route Information



TAMU Mobile App
m.tamu.edu

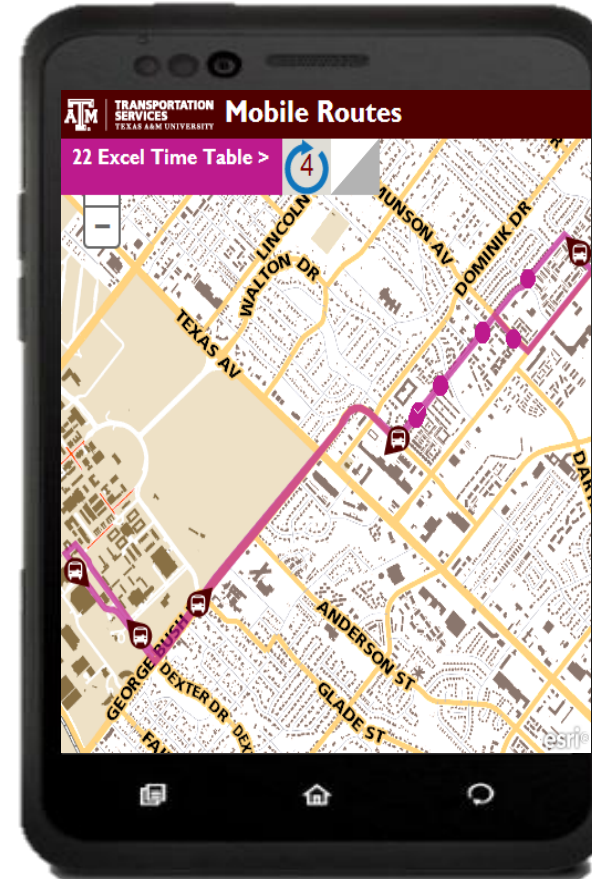

Alternative Transportation

FREE BICYCLE REGISTRATION

Register your bicycle online at "My Account"
<https://transport.tamu.edu/account>

Help identify your bike if lost or stolen
Get bike program news and updates
Be a part of a growing bike program at A&M



transport.tamu.edu

BORROW A BIKE
transport.tamu.edu



PARK N RIDE



It's Spring – Make a Break For It.

Need a ride home or elsewhere? Ride Share has you covered.
transport.tamu.edu/rideshare



Moving Forward for You.



Need a car or truck for an hour? Or longer?

On-campus rental for as little as \$7.50/hr through Zip Car.
transport.tamu.edu/carshare



Moving Forward for You.



Bike Lease

Semester leases on bike shop quality bicycles available for only \$50!



m.tamu.edu/busroutes

Access **schedules,**
maps, **real time**
info on bus routes,
and more!



Follow

Transportation
Services on Twitter

@AggieParking
@AggieSpiritBus
@GetToAggieGame

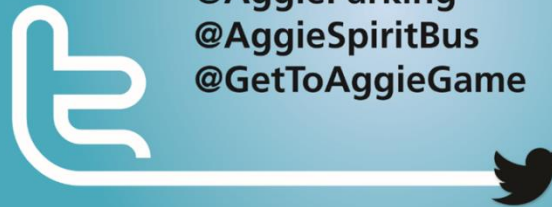

Easily stay informed



with the latest
news from
Transportation Services

Online 
Click to chat

Live one-on-one support for your Transportation Services Questions

transport.tamu.edu



**TRANSPORTATION
SERVICES**

979.862.PARK
transport.tamu.edu



TRANSPORTATION SERVICES



@aggieparking



@aggiespiritbus



@GetToAggieGame

Transportation Services

Customer Assistance Center

108 Koldus

979.862.PARK

parking@tamu.edu

transport.tamu.edu



Meal Plans 2016-2017

University Dining

THINGS TO KNOW

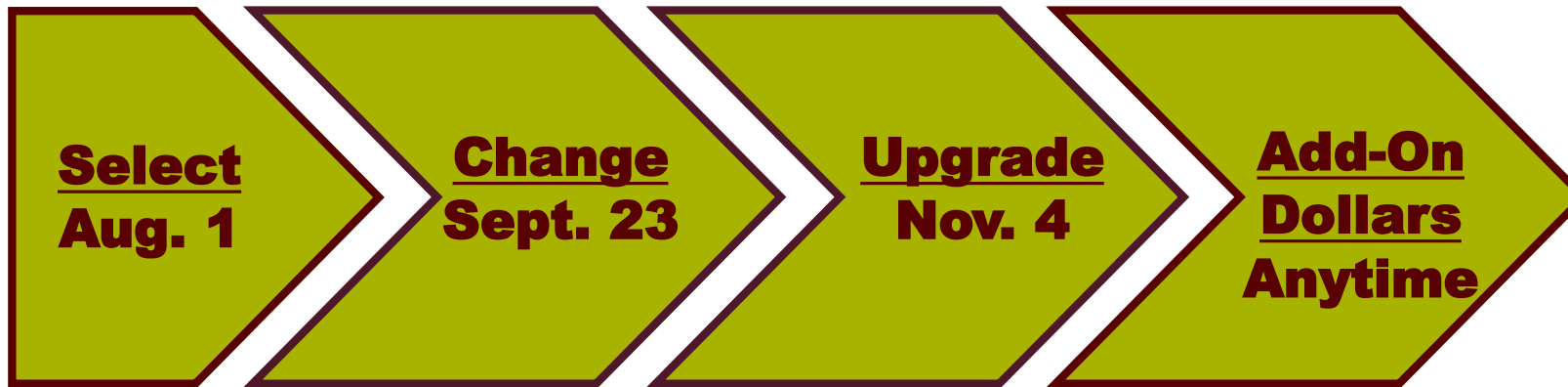

You can check your balance on the Howdy portal!



@aggiedining
#wefeedaggies



Aggie Dining
#wefeedaggies



@aggiedining
#wefeedaggies



979-845-3005

dineoncampus.com/tamu

TAMUMealPlans
@compass-usa.com

FOR DINING INFORMATION AND MEAL PLAN CHANGES



Instagram

@aggiedining

#wesaidhowdy

One winner will receive \$100 Dining Dollars!



Texas A&M
Information Technology

ELEVATE
YOUR EDU

WELCOME TO TEXAS A&M

IT.tamu.edu

- Everything IT at Texas A&M

Help Desk Central

- 24/7 help with all tech-related problems

Reminder:

- Set up Self-Service Password Reset, Code Maroon and Parent Access!

Campus TV

IPTV: the newest way to watch television - without TVs, cables or antennas

IPTV Only

- White Creek
- Corps Halls 1-5

IPTV + Cable

- Gardens Apartments
- Hullabaloo Hall
- Corps Halls 6-8

Cable Only

- All other residence halls

Campus TV

Devices that will work for IPTV:

- Desktop
- Laptop
- Tablet
- Smartphone
- Apple TV
- TV+Roku

See u.tamu.edu/IPTV for more details!

Campus Internet

ResNet: Wired High-Speed Internet

- Available in all Residence Halls
- Bring your own 15-20 foot Ethernet cable
- Your computer must have an Ethernet port

TAMULink: Campus Wi-Fi

- Can connect laptops, smartphones and tablets
 1. Find “TAMULink-WPA”
 2. Log in with your NetID and password

Wireless Rules

DO NOT set up
your own Wi-Fi.

✦ **CONSEQUENCES:** No internet / Student Conflict Services

Wireless Rules

Hall Wireless SPEED

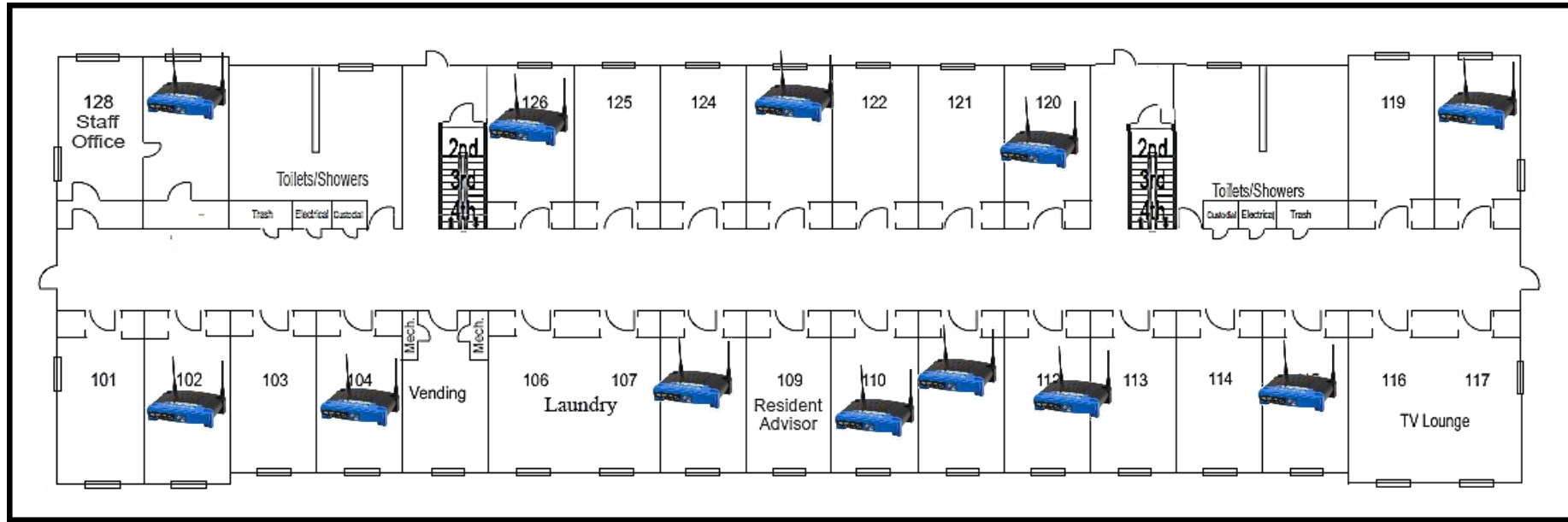
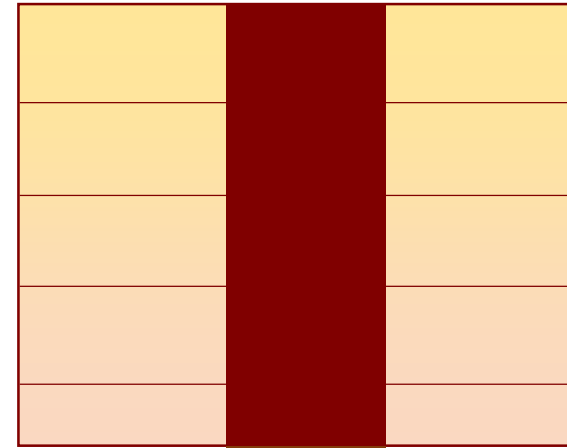



✧ **CONSEQUENCES:** No internet / Student Conflict Services

Wireless Rules

- Must have antivirus installed
 - FREE at software.tamu.edu
- No illegal file sharing or inappropriate use
- Devices must not create a wireless signal – including printers, routers and gaming systems

✧ **CONSEQUENCES:** No internet / Student Conflict Services

Entertainment Tech

 Devices that WILL connect with a wired connection through a router	 Devices with wireless capability and NO <u>TAMULink-WPA compatibility</u> WILL NOT CONNECT	 Devices that WILL connect with Bluetooth to personal electronics (computer, phone, etc.)
<ul style="list-style-type: none">• Smart TVs (if equipped with an Ethernet port)*• TV Boxes (Amazon Fire TV; Apple TV; Roku; Chromecast, with Google Ethernet adapter etc.)• Printers• Network-capable hard drives***• Video game consoles (Playstation, XBox, Wii)	<ul style="list-style-type: none">• TV Sticks (Amazon Fire TV Stick; Roku Stick; etc.)• TIVO, DVRs, etc.• eReaders that are not compatible with WPA2-Enterprise• WI-FI enabled speakers• Most hand-held video game devices• Most consumer electronics that don't have WPA2-Enterprise capability (Appliances, scales, light bulbs and projectors that connect to WI-FI)	<ul style="list-style-type: none">• Health Trackers (Fitbit, Withings, etc.)• Bluetooth computer accessories (mouse, keyboard, etc.)• Printers with bluetooth capability• Bluetooth speakers



[IT.tamu.edu/getstarted](https://it.tamu.edu/getstarted)

Texas A&M Information Technology

NEW AGGIE

TechList

Get prepared to tackle your first semester with tailored IT advice!

GET STARTED



Texas A&M
Information Technology

it.tamu.edu
979-845-8300

1. Like IT and win!



TamulT



@Tamu_IT



2. Caption IT and win again!



@TAMU_IT



Texas A&M
Information
Technology



@TAMUIT



Texas A&M
Information
Technology

Contact Help Desk Central if you have any questions!



CALL

979.845.8300

CLICK

helpdesk.tamu.edu

CHAT

hdc.tamu.edu 8 a.m. to midnight every day

COME BY

DPC/Computing Services Annex, Room 104

Need-to-knows about on-campus living

Live at the Heart of the Aggie Experience!



DEPARTMENT OF
RESIDENCE LIFE

979-862-3158
RESLIFE.TAMU.EDU

Your Residence Life Staff

Resident Advisor/Apartment Resident Advisor

A student staff member who lives in your facility on your ramp, wing, floor, or balcony, who builds community and supports you and your fellow residents.

Graduate Hall Director/Graduate Resident Manager

A graduate student who lives in your residence hall or apartment and is responsible for the overall management and community building within your residence hall.

Community Director/ Resident Manager

A full-time professional responsible for the overall management and community building within your residence life facility.

Residence Life Coordinator

A full-time professional who supervises several Community Directors and oversees a specific section within on campus living.



What does an RA do?

- RA's are students just like you!
- If you have a question, go see your RA.
- If you are having a tough day and need someone to talk to, go see your RA.
- If you have an emergency while in the Residence Hall, go see your RA.
- Don't know where to find something? Check with any RA.
- They are to assist and be a resource for you. When in doubt, check them out!



Policies you need to know: (no, this is not all of them)

- **Escort, Visitation & Overnight Guests**
- **Quiet Hours and Courtesy Hours**
- **Alcohol Use or Possession**
 - All residents must be 21 years of age to have and/or consume alcohol.
- **Abide by all federal and state laws and city ordinances all of the time.**
- **Always abide by all university student rules, regulations and policies.**
- **Drug Use/Abuse and Drug Paraphernalia Possession**
 - Residence hall rooms and apartments are not air tight (smell/odor) nor 100% soundproof. If you deal drugs or abuse them, it is **VERY** hard to hide in our tight-knit residence life communities. You may run the risk of no longer being an Aggie. You may want to think twice now about what habits you bring or start in Aggieland!



Concealed Carry – Texas A&M – College Station

- Concealed handgun license holders **must follow all state and federal laws** concerning owning and possessing a handgun on campus.
- Any resident who:
 - **is licensed** to carry a concealed handgun
 - and chooses to bring the handgun into their residence hall room / apartment
 - **must store the handgun and ammunition** in a safe that has been rented or purchased through the Department of Residence Life when the handgun is not on or about their person.

Additional Information & Updates is posted to our Home Page



Residence Hall Fires Help Limit the Possibility!

- **Leave candles and incense at home!**
- **Do not tamper with fire-life safety equipment in your room, apartment, or in buildings.**
- **Know the policies!**
- **Keep yourself and the residence life community safe!**

Dorm fire injures 2

Damage to A&M hall displaces 192 students

By JOHN KIRSCH
Eagle Staff Writer

Nearly 200 Texas A&M University students escaped injury early Monday morning when fire forced evacuation of a Corps of Cadets dormitory, university officials said.

"There were flames 10 feet out the window. It was pretty bad," said Stephen Henley, 19, a first-floor resident at Whiteley Hall.

The cause of the fire was unknown Monday, but officials said the blaze apparently started in a two-person room on the roof auxiliary's third floor.

Two residents, Michael Muech and Stephen D. Morefield, were treated for smoke inhalation and released from College Station Medical Center, said A&M spokeswoman Mary Jo Powell.

Residents were allowed back in the hall briefly Monday to retrieve belongings. Plans called

for Whiteley Hall.

The Corps' military discipline helped keep the situation under control as students left the building in the early morning.

"Everybody got out in real calm fashion. Some people were even making jokes about it," said Michael Tate, the confined land academic officer.

"There were flames 10 feet out the window. It was pretty bad."

— STEPHEN HENLEY
Whiteley Hall resident

The hall's third and fourth floors were filled with smoke and parts of the third floor were in flames when firefighters arrived shortly after 3 a.m. at Whiteley Hall, on the south end of the Corps' Good area near Duesch Dining Center.

Firefighters overcame the nine students remaining in the hall by ladder from a fourth-floor window.

Units from the College Station Fire Department, Bryan Fire Department, University Police Department and A&M Emergency Medical Services responded to the fire.

Most residents of Whiteley Hall

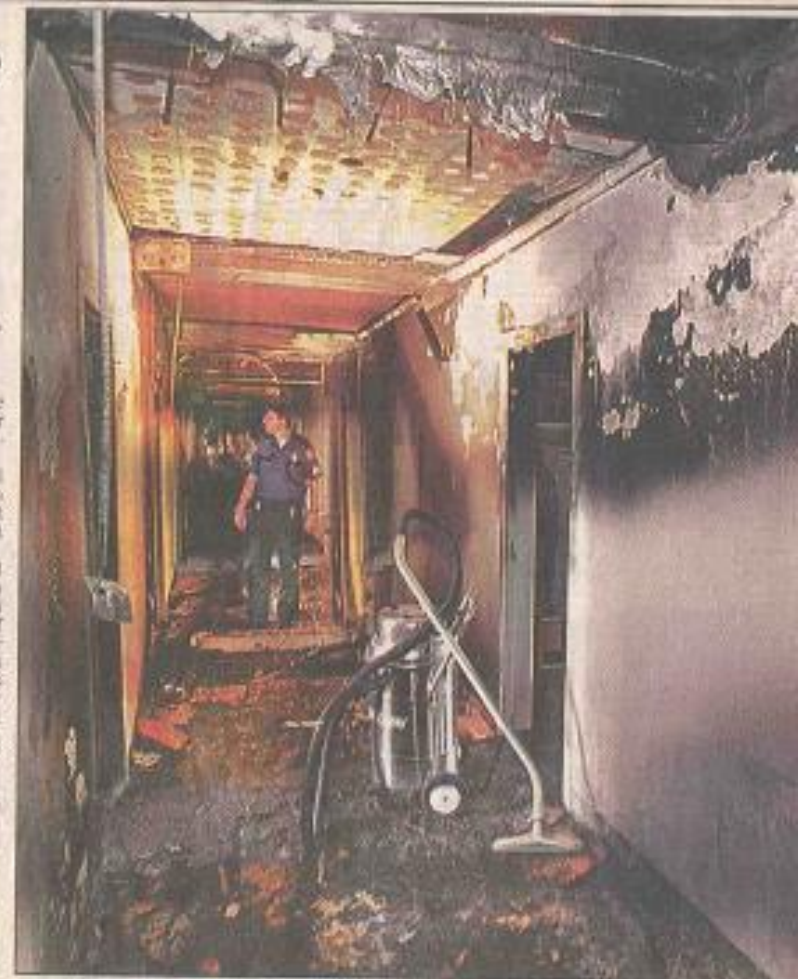

Eagle photo/Dave McD



What NOT to bring

- ✓ **Candles**
- ✓ **Pets**
- ✓ **Halogen Lamps**
- ✓ **Weapons**
 - ✓ Except handguns as permitted by State Law
- ✓ **Prohibited appliances including induction type cookers**
- ✓ **Fireworks, explosives & hazardous items**
- ✓ **Road signs**
- ✓ **Space heaters**
- ✓ **Power tools**
- ✓ **Extension Cords**
 - *Power strips will be available for purchase through the Department of Residence Life website.*

Do not violate policies, for the safety and security of yourself and fellow Aggies!



What you CAN bring

- ✓ **UL approved power strips w/ built-in circuit breaker**
(Available for purchase)
- ✓ **Alarm clock**
- ✓ **Ethernet cable**
- ✓ **Co-axial cable (Halls & Gardens only)**
- ✓ **Wastebasket**
- ✓ **Toilet paper - only supplied in community bathrooms**
- ✓ **Computer**
- ✓ **Shower caddy**
- ✓ **Academic supplies**
- ✓ **Decorations**
- ✓ **Laundry basket(s) or laundry bag(s)**

Wax warmers (“scentsy-type”) that use a 25 watt bulb in a ceramic container to heat scented wax are allowed, but should never be left unattended.



Things to know

- **Consult with your roommate on appliances**
- **4.4 Cubic Feet Fridges/Freezer combo**
- **700 Watt Microwave Oven (only 1 per room)**
 - **White Creek- Only the microwave provided is allowed**
- **Micro Chill models available for rent**
 - **It's a refrigerator/freezer/microwave combo**
- **Painting needs to be approved by hall staff before you paint.**
 - **No painting allowed in Hullabaloo Hall, FHK Complex, or White Creek Apartments**
- **Use 3M Command Adhesive Strips/Hooks with a tab to hang items on walls/doors.**

See your Housing Brochure or our website for more info



Community & Personal Safety

- Do not allow tailgaters into the residence halls or apartments.
- Lock your doors
- Do not prop doors
- Report any suspicious people or negative activities to University Police (UPD) and your residence life staff immediately.
- Our *C.O.P.S.* Program



Personal Property Insurance

- Reasonable steps are taken to maintain all university facilities and ground and to provide adequate security.
- Texas A&M University is not liable for loss of or damage to personal
- The University only carries insurance on University-owned buildings and property, which does not cover the cost of replacing residents' property or personal items.
- Students are strongly advised to carry a personal property (i.e. renter's) insurance policy for their belongings while living on campus.
- Texas A&M University has made arrangements with Arthur J. Gallagher & Co. as their preferred provider to offer specialized student property protection. Brochure was emailed to each of you, but website is below.
 - www.collegestudentinsurance.com



Make Sustainability an Aggie tradition On Campus

Look for ways you can contribute and make a difference

Take the **Sustainability Pledge** at <http://sustainability.tamu.edu>

Consider becoming an **Aggie Eco-Rep** for your residence hall.

Reduce (conserve resources)

Only do full loads of laundry

Use power strips & turn power off when not in use

Report items that need attention from maintenance

Use a drying rack

Turn lights out when leaving the room

Re-use (avoid disposables or re-purpose)

Carry re-usable bags for purchases & to transport items.

Use re-fillable water bottles (BPA-free or steel preferably)

Recycle (divert resources from the landfill)

Locate recycling containers nearest you—in hall, in area, across campus

Recycle: paper, aluminum, plastic, cardboard, & batteries

For more information go to <http://reslife.tamu.edu/gogreen/>



Let's Talk About Roommates



DEPARTMENT OF
RESIDENCE LIFE

979-862-3158
RESLIFE.TAMU.EDU

Common Roommate Issues

(Things you NEED to discuss early or regularly!)

- **Study habits**
- **Cleanliness**
- **Guests**
- **Noise levels**
- **Phone and computer usage**
- **Use of your space/stuff**
- **Borrowing items**
- **Personal preferences**
- **Sleep habits/Needs**



Developing a Great Roommate Relationship

- ✓ **Demonstrate respect**
- ✓ **Act responsibly**
- ✓ **Be willing to compromise**
- ✓ **Learn each other's study habits**
- ✓ **Be flexible and understanding**
- ✓ **Treat each other with dignity**
- ✓ **Practice open communication**
- ✓ **Have integrity**



Living Learning Programs



DEPARTMENT OF
RESIDENCE LIFE

979-862-3158
RESLIFE.TAMU.EDU

A Living Learning Program (LLP) is a residential clustering of students who share academic or social and cultural interests.

Academic Residential Experience Districts

- Engineering Living Learning Community
- Honors Housing Community

Academic Living Learning Communities

- Leadership Living Learning Community
- Spanish Immersion Living Learning Community
- Startup Living Learning Community

Enhanced Living Learning Communities

- ACREW
- Century Scholars Program
- FOCUS Learning Community
- POSSE

Themes or Interest Group Housing

- Education and Human Development
- Liberal Arts Cornerstone Honors
- THRIVE: Wellness Living Learning Community



Academic Peer Mentors



DEPARTMENT OF
RESIDENCE LIFE

979-862-3158
RESLIFE.TAMU.EDU

About the APMs

APMs support students' academic and social development by connecting students with resources and programs to enhance student learning.

Who they are:

- Trained students
- Invested in their peers
- Upper class
- Residential students

Events and Services Offered:

- eCampus
 - Academics in Residence
 - Connection portal to resources
- A.S.K. Sessions
 - In-person
 - Online
- A.C.D.C.s
 - Dialogues offered at the hall/apartment level
 - Community Building
 - Academic Semi-Structure Discussions
- ASSIST Programs
 - Study Skill Development
 - Offered Monthly



Community Learning Centers



DEPARTMENT OF
RESIDENCE LIFE

979-862-3158
RESLIFE.TAMU.EDU

About the CLCs

The **Community Learning Centers** are hubs of academic support and are open to all Texas A&M University Students.

Locations:

- Northside CLC
- Coming Soon:
 - Southside CLC in The Commons
 - West Campus CLC near White Creek

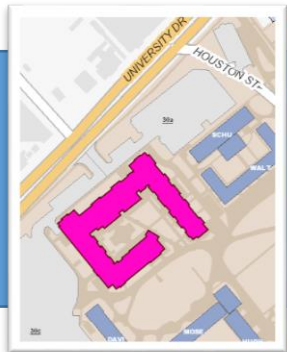

Northside
Hullabaloo Hall 126

Hours of Operation:

Days	Hours
Sunday	12:00p.m. – 12:00a.m.
Monday-Thursday	7:00a.m. – 2:00a.m.
Friday	7:00a.m. - 9:00p.m.
Saturday	9:00a.m. – 9:00p.m.



About the CLCs

Amenities:

- Open Access Labs with printing
- Private/Group Study Rooms
- Large Study Spaces
- Rolling Dry Erase Boards
- Multi-Port Group Project Tables
- Paper Cutters, Scanning Copier
- Resource Books to Check Out
- Large Monitors to Connect Computers



Residential Tutoring



DEPARTMENT OF
RESIDENCE LIFE

979-862-3158
RESLIFE.TAMU.EDU

About Residential Tutoring

Residence Life collaborates with the Academic Success Center to offer tutoring in our residence halls and apartments.

Locations:

- ▶ Hullabaloo 105
- ▶ White Creek
- ▶ Coming Soon:
 - ▶ Southside Commons



Northside
Hullabaloo Hall 105

Hours of Operation:

Days	Hours
Sunday-Thursday	5:00p.m. – 9:00p.m.



White Creek
Apartments Building
1590A (Activity Center)



Events & Spaces



DEPARTMENT OF
RESIDENCE LIFE

979-862-3158
RESLIFE.TAMU.EDU

Events and Spaces



Cornerstone Honors students attending one of Dr. Sumpter's honors courses



Events:

- Residential Tutoring
- Dinner with a Prof
- Study Spectacular
- Commit to Success Classes

Spaces:

- Individual and Group Study Spaces
- Special Use Spaces
 - Used by:
 - Classes
 - Student Groups/Organization
 - Non-TAMU groups



Staff Council Linens

- **Sales generated funding is utilized for community events and activities in Residence Life facilities.**
- **Brochures will be sent to you this summer.**
- **Linen orders do not require a room number, because linens will fit all our mattresses and will be sent directly to your home before you move into your residence hall or apartment.**



Residence Life Move-In Assistance Day

Move-In Assistance only offered on Sunday, August 21st

You can move in anytime:
Beginning Aug. 21st at 8:00 a.m. - 5:00 p.m. for the Residence Halls
up until the day before classes begin.



DEPARTMENT OF
RESIDENCE LIFE

979-862-3158
RESLIFE.TAMU.EDU

Receiving Your Mail – Northside/Southside/White Creek

Options Available to you to receive your mail:

Hullabaloo Hall (Postal Plus):

Located on 1st floor of Hullabaloo Hall (Northside Hall) (979.268.7727)

Northgate Station (USPS):

On the corner, University Drive & Houston Street

Southside (Postal Plus):

Adams Band Hall (979.268.7727)

White Creek (Postal Plus):

Building A Mailboxes (979.268.7727)

- *Mailboxes at White Creek are included in the rent and do not need to purchase a mailbox through Postal Plus*
- *Texas A&M does not deliver mail addressed to residence hall rooms.*
- *UPS and Fed Ex can deliver to student rooms (Must be present)*

Questions? Visit reslife.tamu.edu/faq



Residence Hall Tours

**Monday - Friday:
10:00 am - 4:00 pm**

- *Leaving every hour from the Hullabaloo Lobby*
- *10:00am, 11:00am, 12:00pm, 1:00pm, 2:00pm, 3:00pm, 4:00pm*
- *Last tour starts at 4:00pm*
- *Tours last approximately 45 minutes*
- *White Creek Apartment Tour schedule will be posted on the Residence Life Website*

Note: You may not see the hall you will live in, but another in the same style!

Check the Department of Residence Life website for updates and additional information on tour times and dates.



DEPARTMENT OF
RESIDENCE LIFE

979-862-3158
RESLIFE.TAMU.EDU

Housing Assignments Office

Located in A3 Lounge (Next to Davis-Gary & Moses Halls/Parking lot 30)

Contact us:

- Phone: 979.845.4744
- E-mail: housing@tamu.edu
- Website: <http://reslife.tamu.edu>

Our Office Hours: Monday – Friday, 8:00 a.m. – 5:00 p.m.



DEPARTMENT OF
RESIDENCE LIFE

979-862-3158
RESLIFE.TAMU.EDU

Housing Assignments

Here to serve you!

- **Assignments notifications are emailed out in batches**
 - **Most sent end of May**
 - **Others follow every 2 weeks**

- **Assignments and room/suitemate info can be viewed online at:**

<http://reslife.tamu.edu/onlineservices>



Housing Assignments

Here to serve you!

- **Requests for hall/apartment changes & room changes may be made until August 1 or the first day of class.**
- **Request for “roommate swaps” can be made online at <http://reslife.tamu.edu/onlineservices/hallchangerequest>**
- **Cancellations more than 7 days after you were assigned will result in a 25% surcharge penalty until the first day of class**





@TAMUResLife
#tamulifeoncampus



tamureshalls



@TAMUResLife
#tamulifeoncampus



Still have questions?

We will be outside the theater (first floor)
to answer your questions!

Visit us on the web:

<http://reslife.tamu.edu>

Have a great summer, we'll see you in August!
Thanks and Gig 'em.